

REV.	CNN	CNN DESCRIPTION	Date	Check in
06	-	TABLE ADDED	17/02/2010	Shaun Barron
06	-	TABLE ADDED	18/02/2010	Shaun Barron

A standard 4mm plug, with a rigid, screw on acetal body which comes in a range of colours for easy identification.
 This range of product caters for a broad range of test instrumentation and speaker applications.
 The plug pin comes with a solder bucket for secure cable fixing.

Part	550	
Insulant	Acetal-LG chemical LUCEL N127-LD/DN127-LD	Acetal C27021 R
Socket	Brass BS 2874 silver plated	
Spring		
Amps	10A	
Nominal working Voltage	50V	
Contact Resistance	10mΩ	
Maximum Temperature RTI	+ 110°C	
Minimum temperature	- 20°C	
Recommended Temperature	10A @55°C	
Voltage Breakdown	5000v	
Conductor size	1.5mm ²	
Colours	550-0100	Black
	550-0200	Blue
	550-0300	Brown
	550-0400	Green
	550-0500	Red
	550-0600	White
	550-0700	Yellow

Dimensions

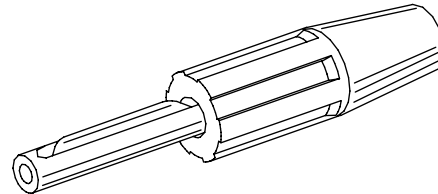
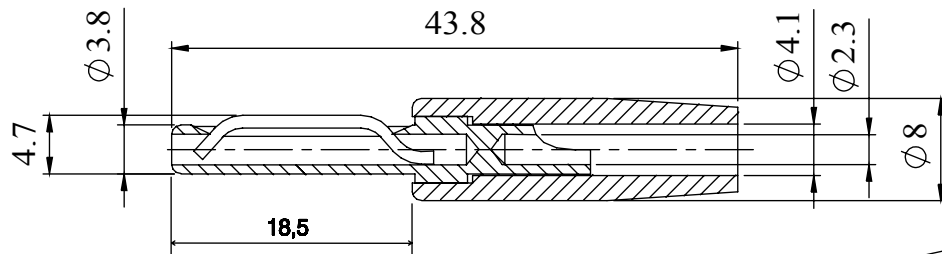

STANDARD 4mm PLUG – SOLDER BUCKET

Tel No. +44(0)1724 273200 Website www.dem-uk.com

PROPRIETARY AND CONFIDENTIAL
 THE INFORMATION CONTAINED IN THIS DRAWING IS THE SOLE PROPERTY OF
 ALPHA 3 MANUFACTURING.
 ANY REPRODUCTION IN PART OR AS A WHOLE WITHOUT THE WRITTEN PERMISSION OF
 ALPHA 3 MANUFACTURING IS PROHIBITED.

UNLESS OTHERWISE SPECIFIED:
 DIMENSIONS ARE IN MILLIMETRES
 LINEAR TOLERANCE:
NO DECIMAL PLACES ±0.5mm
1 DECIMAL PLACE ±0.25mm
2 DECIMAL PLACES ±0.125mm
 ANGULAR TOLERANCE: ±1°

DEM Manufacturing, Deltron Emcon House
 Hargreaves Way, Sawcliffe Ind. Park,
 Scunthorpe, North Lincolnshire, DN15 8RF, UK



FINISH	-	DEBURR AND BREAK SHARP EDGES	DRAWN BY	SPB	TITLE	GENERAL SPECIFICATION	
	-		APPROVED BY	WC		550 SERIES 4mm PLUG	
			THIRD ANGLE PROJECTION	SHEET 1 OF 1	DRAWING NO.	550 SERIES	ISSUE 06
	IF IN DOUBT ASK DO NOT SCALE DRAWING			SCALE 1:1			Release
MATERIAL	-			A4			